

ITEM NO.	PART NUMBER	DESCRIPTION	MATERIAL	DRAWING #	QTY.
1	FP-LL STRAP 10.1875	LEVEL LOK MOUNTING STRAP 10-3/16"	ST-FI 3/8x2-3/4"	90-2821	1
2	FP-RT 4X3X.1875 L 2	LENGTH 2"	RT 4x3x3/16"	STOCK	1

**FP-DLL1-2 DS  
DRIVER SIDE DLL-1 CENTER BRKT  
4.30 LBS.**

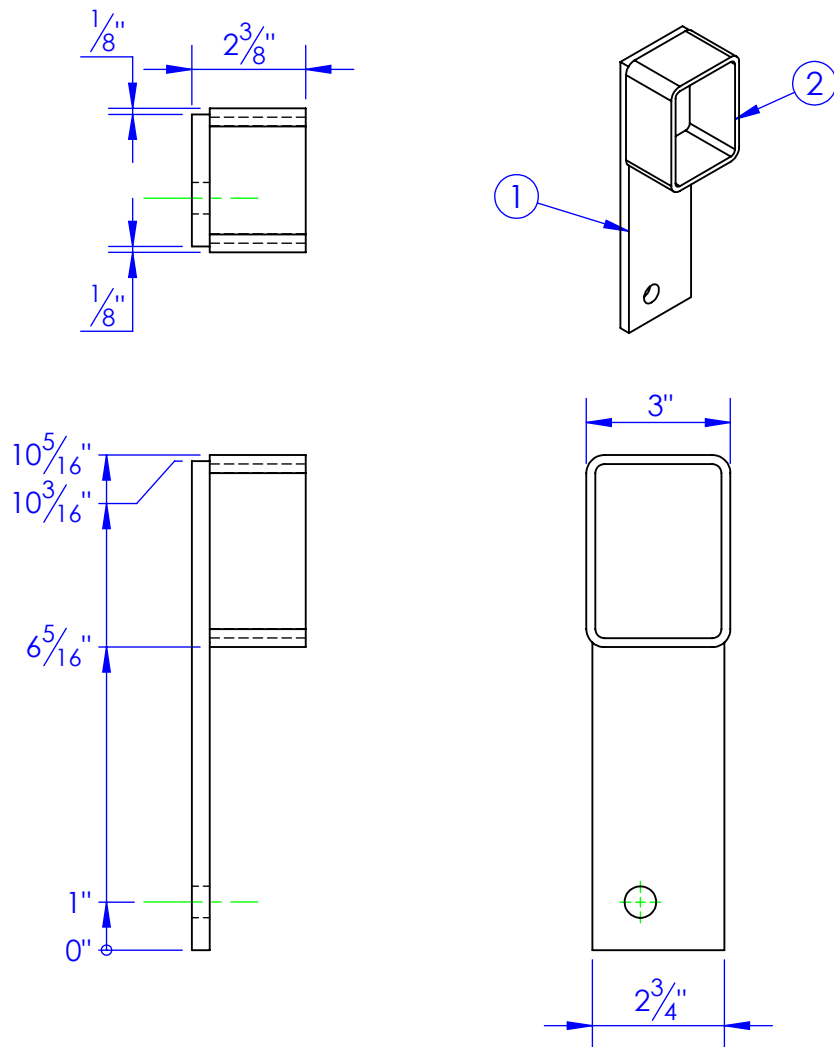

ITEM NO.	PART NUMBER	DESCRIPTION	MATERIAL	DRAWING #	QTY.
1	FP-LL STRAP 10.1875	LEVEL LOK MOUNTING STRAP 10-3/16"	ST-FI 3/8x2-3/4"	90-2821	1
2	FP-RT 4X3X.1875 L 2	LENGTH 2"	RT 4x3x3/16"	STOCK	1

**FP-DLL1-2 PS  
PASSENGER SIDE DLL-1 CENTER BRKT  
4.30 LBS.**

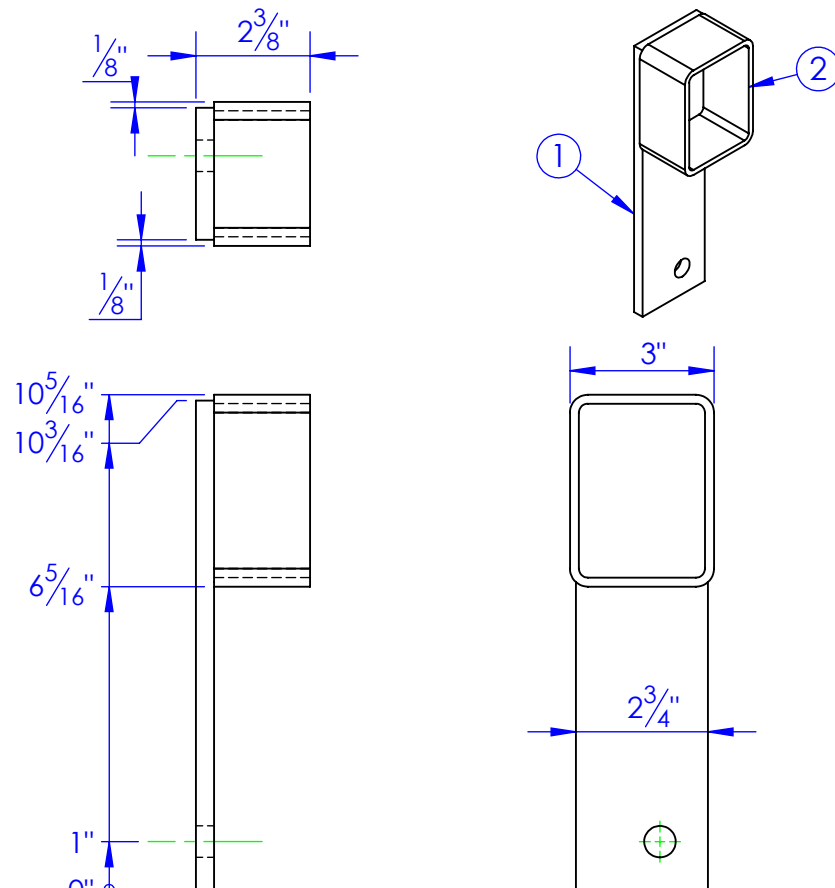

REV.	REVISIONS	DATE
A	UPDATED TO NEW DWG FROM 10-1824 C	1/22/2013

**PROPRIETARY AND CONFIDENTIAL**  
THE INFORMATION CONTAINED IN THIS DRAWING IS THE SOLE PROPERTY OF TRIPLE C INC. ANY REPRODUCTION IN PART OR AS A WHOLE WITHOUT THE WRITTEN PERMISSION OF TRIPLE C INC. IS PROHIBITED.

DIMENSIONS ARE IN INCHES TOLERANCES: FRACTIONAL $\pm 1/16$ ANGULAR: MACH $\pm 1$ BEND $\pm$ TWO PLACE DECIMAL $\pm 010$ THREE PLACE DECIMAL $\pm 005$	
MATERIAL	--
DO NOT SCALE DRAWING	

NAME	DATE
DRAWN <b>HEATH</b>	1/22/2013
PART #	SEE DWG
ASM #	
COMMENTS: <b>CENTER BRACKET DLL-1 WLDMT.</b>	

P.O. BOX 248, SABETHA, KS 66534	
<b>TRIPLE C</b> INC.	
SIZE <b>A</b>	DWG. NO. <b>90-1821-24</b>
SCALE:1:3	WEIGHT: --
SHEET 1 OF 1	